

BUMPERDRONE MINI

EI-7823b
MFR No. 84820

ENGLISH

A. Content Delivery (See picture A)
A1. Bumper Drone Mini A2. Transmitter A3. Spare Propellers A4. USB Recharge Cable A5. Instruction Manual

B. Part Identification (See picture B)

Bumper Drone Mini		Transmitter	
1. Propeller	4. Transmitter Power Indicator	7. Yaw Trimmer (L / R)	10. Roll Trimmer (L / R)
2. Bumper	5. Ascend button	8. Pitch Trimmer (FWD / BWD)	11. Battery Cover
3. Direction Stick	6. Power Switch	9. Descend button	12. Trimmer Cover

B1. Using a fork or tool, gently pry the blade from the motor shaft.
B2. Replace new correct propeller.
B3. When replacing the rotor, please make sure the arrows on both Drone and propeller are in the same direction.

C. Battery Installation and Charging (See picture C)
Transmitter Battery Installation
C1. Press down the button (1) on the transmitter, and then follow the arrow (2) direction to push out the battery compartment cover.
C2. Insert 2 AAA batteries in the battery compartment with correct polarity.
C3. Close the battery compartment.
Charging the Drone
C4. Connect the USB cable to a USB socket.
C5. Switch off the drone. Insert DC plug into the charging socket on the drone. The charging process will begin automatically and the green LED on drone will light up.
C6. Unplug the charging plug when the LED turns off, charging is completed.

Note: 1. The Drone can operate for about 4 - 5 minutes per every 30-45 minutes charging.
2. Before recharging the battery, wait 10 - 15 minutes for it to cool down.

D. Flying the Drone (See picture D)
Tip: Piloting hints
- For controlling the sticks on transmitter, try not to push the sticks immediately to any extreme positions. It should be like steering a bicycle rather than crossing computer game sticks. For the novice pilot (after the trimming procedure is completed), it is highly recommended to focus exclusively on learning to control the left stick first. If the Drone turns around by itself there is no need to keep it straight. For the first flight, it is important to learn to keep the Drone at a constant left of around 1 meter with very gentle inputs on the left stick. Once the pilot masters this, he may start learning to take control with the right stick.

1. Procedure for PAIR / SYNC the Drone and Transmitter
2.4 GHz technology allows for many Drone to fly without signal interference. A connection, PAIR / SYNC, must be made between the Drone and the transmitter to function. Follow these steps to PAIR/SYNC the Drone and the transmitter.
- Turn the Power Switch button to "ON" position on the Drone, the LED will gradually fade in and out. (D1)
- Place the Drone on the ground with the tail pointing towards you and the nose pointing away.
- Turn the Power Switch on Transmitter to "ON" position, the LED will gradually fade in and out. (D2)
- When the LED on Transmitter become solid and LEDs on Drone flash regularly, the pair procedure is completed. (D3)

2. Self Calibration
Place the Drone on a horizontal surface.
Pull the direction stick to lower left corner and press and hold "Descend" button (D4) for 8 seconds. You will hear a "beep" sound. The rotors will spin and calibration proceeds. When "beep beep beep" sound presents meaning that the calibration is completed. You can control the Drone now. (Only do the Self Calibration when unstable flying of Drone is happened.)

3. Flight environment
Indoor environment with calm air. Beware of the air circulation from the air-conditioner.
Caution: There must not be any dangerous objects (electric fan, air-conditioner, reading lamp, etc) on the flight path.

Warning!

Remove these batteries from the unit by pulling up on one end of each battery positive by hand.

DO NOT remove or install batteries using sharp or metal tools.

A Content Delivery

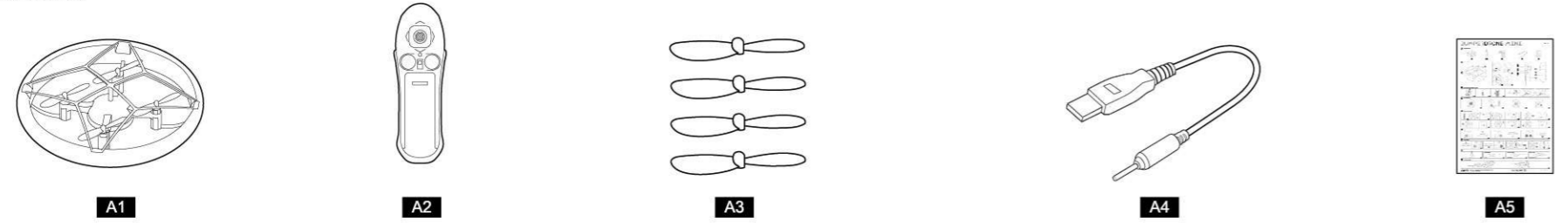

B Part Identification

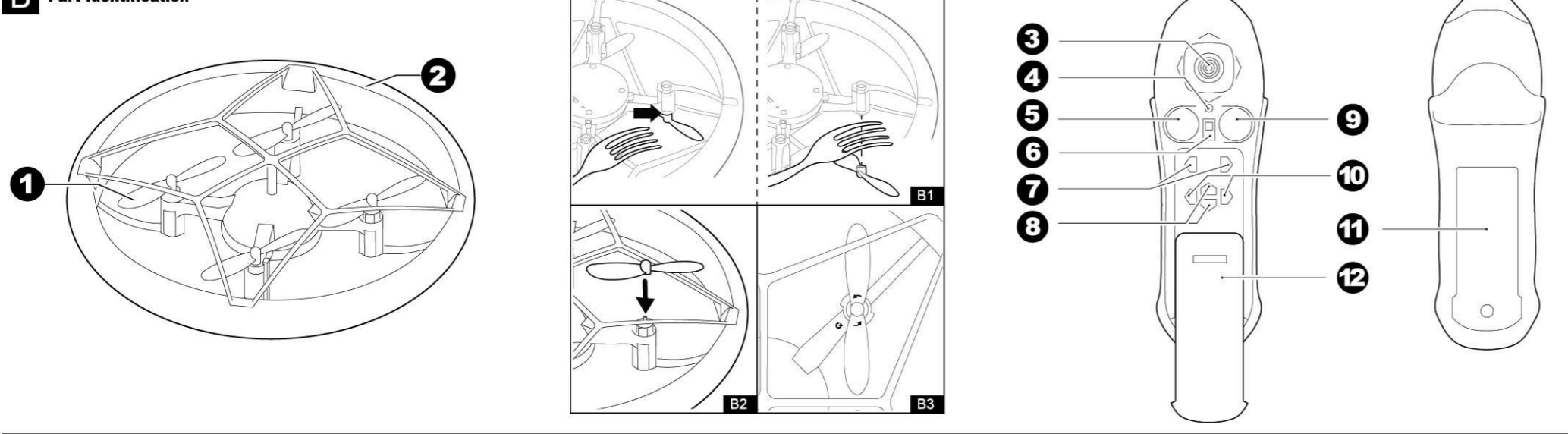

C Battery Installation and Charging

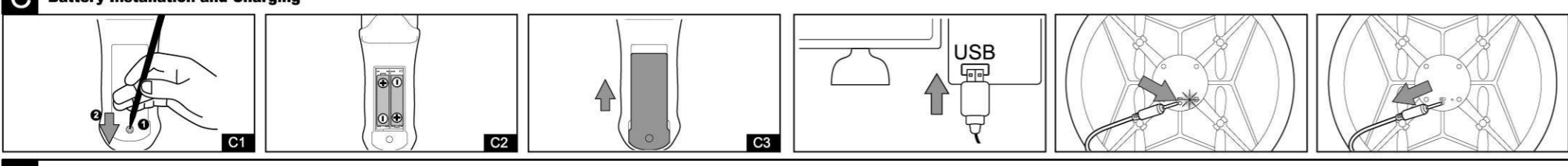

D Flying the Drone

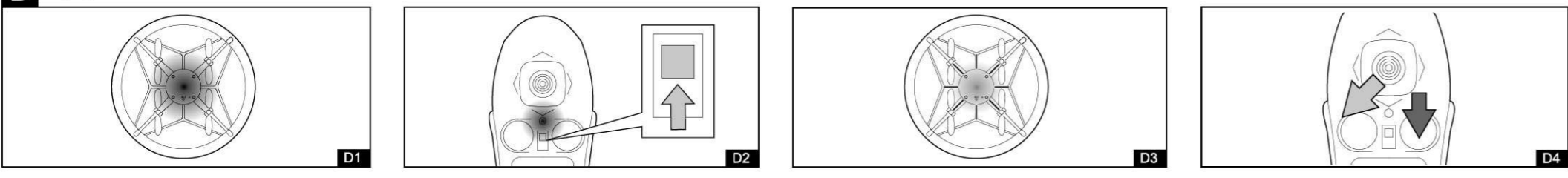

E Trimming the Drone

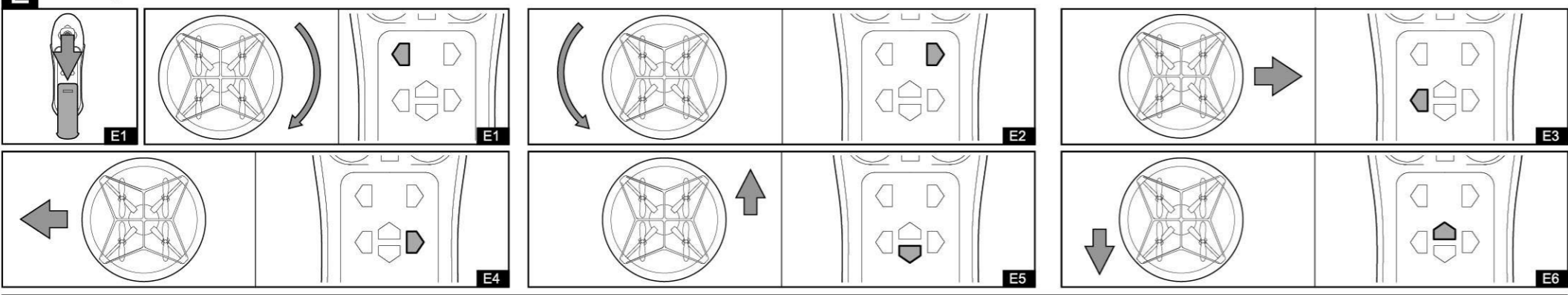

F Flight control: Take off and landing

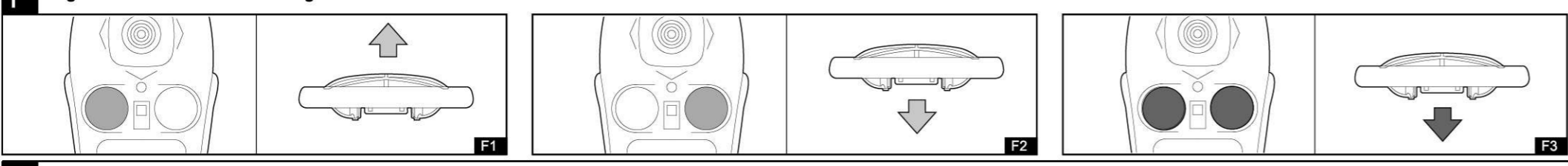

G Flight control

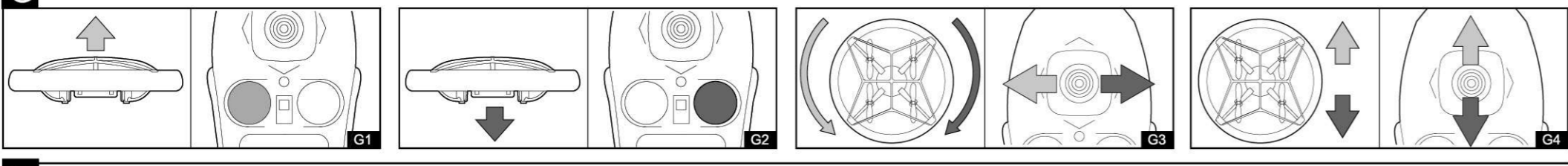

H Fly mode setting (Beginner / Intermediates / Advanced Mode)

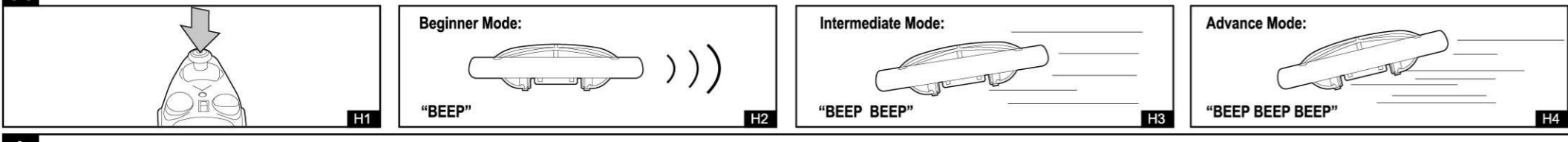

I Protective Bumper

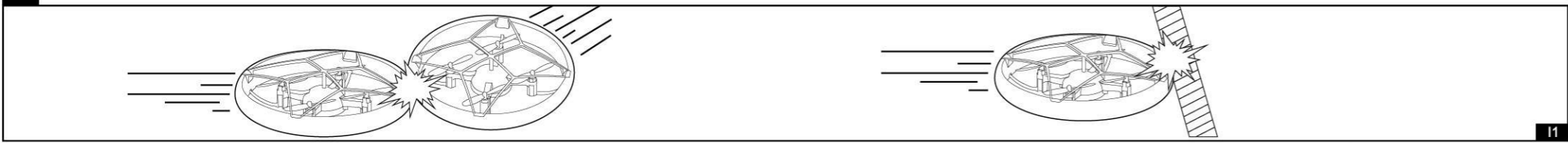

E. Trimming the Drone (See picture E)

Press the Ascend button to take-off the Drone about 0.5 to 1 meter above the ground.

E1: Keep turning right - When your Drone keeps turning right, press left side of Yaw Trimmer continually until it stops turning.	E4: Keep going left - When your Drone keeps rolling sideways to left, press right side of Roll Trimmer continually until it stops rolling.
E2: Keep turning left - When your Drone keeps turning left, press right side of the Yaw Trimmer continually until it stops turning.	E5: Keep going forward - When your Drone keeps going forward, press backward of Pitch Trimmer continually until it stops going forward.
E3: Keep going right - When your Drone keeps rolling sideways to right, press left side of Roll Trimmer continually until it stops rolling.	E6: Keep going backward - When your Drone keeps going backward, press forward of the Pitch Trimmer continually until it stops going backward.

F. Flight control: Take off and landing (See picture F)

Auto take-off & landing:
Press "Ascend" button (F1), Drone flies up to a standard level and hover in the air.
Press "Descend" button for 2 seconds, Drone will land automatically. (F2)
Press the "Ascend" button and "Descend" button at the same time over 1s for emergency stop. (F3)

G. Flight control (See picture G)

G1: Ascend When the Drone hovering in the air, press the "Ascend" button to ascend the Drone.	G3: Turn left and right Maintain the Drone at a certain height. Push the direction stick toward left to turn the Drone anticlockwise, and push it toward right to turn it clockwise.
G2: Descend When the Drone hovering in the air, press the "Descend" button to descend the Drone.	G4: Forward and backward flight Maintain the Drone at a certain height. Push the direction stick upward to fly the Drone forward, and pull it downward to fly the Drone backward.

H. Fly mode setting (See picture H)

- Vertical press the stick gently (H1) to change between Beginner Mode (beep once) (H2) / Intermediates Mode (beep 2 times) (H3) / Advanced (beep 3 times) (H4)

I. Protective Bumpers

The bumpers are highly protective to keep propellers away from obstacles, to prevent crash and fall.

J. Troubleshooting

Symptom	Cause	Correction
The Drone does not response.	- The Drone and/ or the transmitter is switch off ("OFF"). - The battery of the Drone is weak.	- Set the power switch to "ON". - Charging the battery of drone
The Drone does not react, or react poorly to operation by transmitter.	- PAIRING / SYNC Procedure is not yet completed or done.	- Repeat the PAIR/SYNC procedure again.
Loss of control.	- Out of the control range of distance. - Rotor blade is deformed or distorted.	- The transmission range is up to 30 meters in open space. - Replace the rotor blade with the spare one provided.